



Lutheran Women's Missionary League

MINNESOTA NORTHERN LIGHT



"Serve the Lord with Gladness..." Psalm 100:2

Welcome!

Welcome to the 28th Biennial Convention of the Lutheran Women's Missionary League Minnesota North District!

"See, I have inscribed you on the palms of my hands" (Isaiah 49:16a NKJV). My prayer is that this verse will have new meaning for you as we participate in Bible study. As Lutheran Women in Mission, we will be involved in worship, servant activities, checking out exhibits, and voting. We will make new friends and renew old acquaintances. May the time you spend here in convention refresh and further equip you to go back to your societies and congregations and serve the Lord with gladness in all you do.

To God be the glory!

Marilyn Hiltel, LWML District President

**2018 LWML MN North District
28th Biennial Convention**

June 18 - 20, 2018

Sanford Center,
Bemidji, MN

Hosted by Park I Region

Convention Theme

"Forever Written in His Hands"

Bible Verse

"See, I have inscribed you on
the palms of my hands."

(Isaiah 49:16a NKJV)

In this issue...

President's Welcome	1
Meet and Greet Reception	1
Mites in Action	1
Agenda, Mite Walk, Banners	2
Banner Info, Exhibitors	2
Nuclei Welcome	3
Ingathering/Servant Events	3
Breakout Info, Bible Study	3
Young Women Info	3
LWML Store, Room Locations	4
Convention Site Map	4
Message Board Info	4
Thank You's, Transition Meeting	5
Entertainment	5
Nuclei Team Identification	6
Tourism Info, Exhibit Info	6
Exhibit Hall Info	7
2019 LWML Invitation	7
Mites in Action Speakers	8

Mites in Action Speakers

Several Mission Grant recipients from the 2016-2018 biennium will be sharing stories of what our mites have done in the mission field.

We will hear – Eugene Pasche talk about Orphan Grain Train; Hear exiting news happening at LIC Christ Serve Ranch; Get an update on C.R.O.S.S. Appeal (Congregations Reaching Out to Support Schools) from Janna Kietzman, and last find out more about DOXOLOGY from Rev. Bruce Tlmm. See page 8 of this newsletter for more speaker details.

These speakers will be interspersed throughout the convention schedule on Tuesday and Wednesday. Come hear how supporting Mission Grants through Mites have accomplished great things. To God be the Glory!

Meet and Greet Reception

On Tuesday we will have the opportunity to elect new officers for the next biennium. Tonight (Monday) you will have the opportunity to meet the candidates at an open reception in the lobby of the Sanford Center located by Door 4. Come and visit with the nominees after the worship service (around 8:30 pm).



The mission of the Lutheran Women's Missionary League is to assist each woman of The Lutheran

Church—Missouri Synod in affirming her relationship with the Triune God so that she is enabled to use her gifts in ministry to the world.



ABBREVIATED CONVENTION AGENDA

(See complete agenda in the convention manual.)

Monday, June 18

11-3:15 pm	Servant Events
1:00 pm	Breakout Session I
2:15 pm	Breakout Session II
5:30 pm	Dinner - Lakeview 4-7
7:30 pm	Opening Worship Service with Communion; Convention Offering #1 2018-2020 Mission Goal
8:30 pm	Open Reception/Meet the Candidates-Sanford Center YW Get Together Country Inn & Suites

Tuesday, June 19

7:45 am	Singing
8:00 am	Convention Session Begins
8:30 am	Bible Study with Rev. Bruce Timm
9:30 am	Convention Business/Voting: Resolutions, Mission Grants, Bylaw changes, Convention Offering #2
10:40 am	Keynote Speaker: Cynthia Khan and Joy Markus
12:00-1:00 pm	Lunch
1:00 pm	Singing
1:15 pm	LWML Rep, District Office, LLL (LHM), YWRs, Mites in Action Speakers, Balloting for Officers
4:15 pm	Ingathering Report/Dedication Service; Mites in Action
6:00 pm	Dinner
7:30 pm	Slew Foot Family Band Concert Young Woman Gathering (Following Entertainment)

Wednesday, June 20

6:15-7:30 am	"Walking with Jesus" Mite Walk
7:00-8:00 am	Breakfast
7:45 am	Singing
8:00 am	Opening Devotions by Young Women; Convention Offering #3; Mites in Action Speakers; President's Report
9:30 am	Bible Study #2 with Rev. Bruce Timm
10:30 am	Invitations, Introduction of Nuclei Committee and Workers; Closing Worship and Installation of New Officers.
12:00 pm	Adjournment Transition of Officers



Walking with Jesus Mite Walk

Wed., June 22, 6:15-7:30 am

The Mite Walk, "Walking With Jesus", takes place on Wednesday morning, June 20.

Instructions for those who are participating:

- Meet at Door 4 of the Sanford Center (between 6:15 and 6:30 am). Drop off your medical release & pledge forms and pick up water/snack bars. (There will be medical release forms available plus some t-shirts for purchase.)
- 7:00 am – A photo will be taken of walkers at the Rotary Gazebo (1 1/3 miles from the Convention Center.) The walk will end at 7:30 am.
- Walkers who choose not to walk as far as the Gazebo will have their picture taken at Door 4 of the Convention Center.
- Walkers may take the shuttle back to the Convention Center.
- ENJOY THE WALK; there will be time to enjoy the convention breakfast following it!



Zone Banners

Zone Presidents: When you come to the convention, bring your banner to the Registration Desk, Door 4, at the Sanford Center. An usher will bring you to the room where you will leave your banner (in Ballroom 1, behind the Registration Area). At 7:30 am on Tuesday, June 19, pick up your banner in the Exhibit Hall (Ballroom 1) and put it on the pole. Take it into the hall where we will line up for the banner procession.

Bus Transportation to Monday Evening Worship Service

Trinity Lutheran Church Worship Service will have handicap accessible bus transportation from Conference Door 4, Sanford Center, beginning at 6 pm on Monday, June 18. Please be ready to board the bus. Dinner is at 5:30 pm and the church service has been set for 7:30 pm. If you decide to drive to Trinity Lutheran Church, there is a map in your tour information, marked with a tab.

Welcome to Bemidji!

The women of Park I Region of the LWML MN North District are excited to have you attend the 28th Biennial Convention here on the banks of Lake Bemidji. On behalf of the Nuclei Committee and Teams, it is my privilege to welcome you!

The Nuclei Committee is here at convention to be of assistance to you; they can be recognized by their white tops and black slacks or skirts. Each of the teams has identified themselves with a special scarf or other accessory item (see page 6). If you have a question during convention, just ask us. It is our prayer that each of you is richly blessed through this convention as we remember we are Forever Written in His Hands.

Marcia Wittenburg, Nuclei Committee Chairman



CONVENTION INGATHERINGS AND SERVANT EVENTS

The **Ingathering** collection area will be near the registration desk by Door 4; bring items to Lakeview Room 4. There will be ushers to help you. Large and multiple items will be directed to Door 10 (Loading Dock).

The **Servant Event** area will be in Lakeview 4. Stop by even if you have even a few minutes and see what is happening – you may find something interesting to take back to your zone and/or society! There will be cutting, splicing, and rolling plastic bag strips for those who crochet the plastic sleeping mats. There will be tearing and rolling sheets for bandages plus tying baby blankets and/or Linus blankets. Be sure to check us out! Come join us!



Welcome Young Women!

Whether this is your first district convention, or you've been to one before, I am so glad that you are joining us! Convention is such a fun time to enjoy fellowship with other LCMS women; I'm looking forward to spending the next couple of days with you!

Some items to note:

- As a YWR, you will receive a small token in your registration packet to wear to identify yourself as a YWR. Wear it to convention activities and be on the lookout for other YWRs!
- As time allows, stop by the Young Women booth. Grab some candy, visit with some other YWRs, and get the latest information about where and when we'll be meeting.
- Please join us for our scheduled YWR activities! Both Monday and

Tuesday evening, we will meet in a suite (room number to be announced or check at Young Women booth) at the Country Inn & Suites. We will gather following the convention evening activities – Reception on Monday; Entertainment on Tuesday. Come for snacks and social time – pajamas are allowed!

- We, as YWRs will be eating with LWML MN North President Marilyn Hirtel and LWML Vice President of Organizational Resources Debbie Larson at the Tuesday night dinner. Look for the table marked for "YWRs".
- **Questions? Need help? Want to meet for a meal?** Stop by the Young Women Booth and leave me a message. Or you can text me at 612.963.5586. I'm happy to help!

Beth Dinger

Young Women Chariman

Breakout Session Information

Breakout Sessions will be offered on Monday. On the bottom left corner of your nametag, you will find a two-letter code for the breakout sessions you will be attending. The first letter represents the first session that starts at 1:00 pm. The second letter represents the second session that starts at 2:15 pm. If one of the two letters is an X, it means you did not sign up for that session. Session Letter Code and Breakout Room Location Assignment:

CODE	LOCATION	SESSION LEADER
A	Lakeview 5	Debbie Larson
B	Lakeview 6	Carole Borchers
C	Lakeview 7	Cynthia Khan
X=	No session. You are free to participate in Servant Events or view the exhibit booths.	

Bible Study Leader: Rev. Bruce Timm, St. Cloud, MN

We will be studying the theme passage of our convention, using Isaiah 49 as the nearer context and the book of Isaiah as the greater context. Good Lutherans always ask, "What does this mean?" and then look to God's own Word for the answer. Sometimes, what we think or feel a verse means isn't always what God is saying. Is that the case for this verse? We'll find out as we dig into God's Word and examine Isaiah 49:16.

Lost & Found

There will be room on the Message Board to post Lost & Found items. Any items you find can be turned in at the Registration Table, and they will hold on to them throughout convention. If a purse is found, we will respectfully look through it to see if we can find out the owner's name. If you misplace an item, please describe the item on a note at the Registration Table and post it on the Message Board. We encourage you to put your name on your convention tote as soon as you receive it.

Message Board

We also want you to leave messages on the Message Board for individuals at convention. When writing your message, be sure to include contact information. We encourage everyone to check the Message Board throughout each day of convention in case someone is trying to contact you.



Prayer Requests

"Therefore confess your sins to one another and pray for one another, that you may be healed. The prayer of a righteous person has great power as it is working" (James 5:16).

We will have Prayer Boxes (between Room 5 and 6 of the Main Hall at the Sanford Center) to address prayers of thanksgiving, adoration, and supplications.

Choir Rehearsal information

Choir rehearsal will be held at 4:00 pm on Monday in the Main Convention Hall, Ballrooms 2 & 3.

First Aid Station

We will have a nurse "on call" during convention hours to assist with minor first aid needs. The Nuclei Committee workers will call Kathy Brandt or Marcia Wittenburg if there is an emergency, and we will contact nursing team members.

After the daily convention hours, you will need to seek care at the area hospital or call 911 for assistance. The hospital phone number will also be available on the message board.



LWML Store

The LWML Store is located in the Exhibit Hall (Ballroom 1) and will be open during normal exhibit times. Come check out the new items that are available from LWML!

Remember: All sales are cash or check. Your purchase of LWML products and resources assist the national organization in paying for programs and administrative expenses.

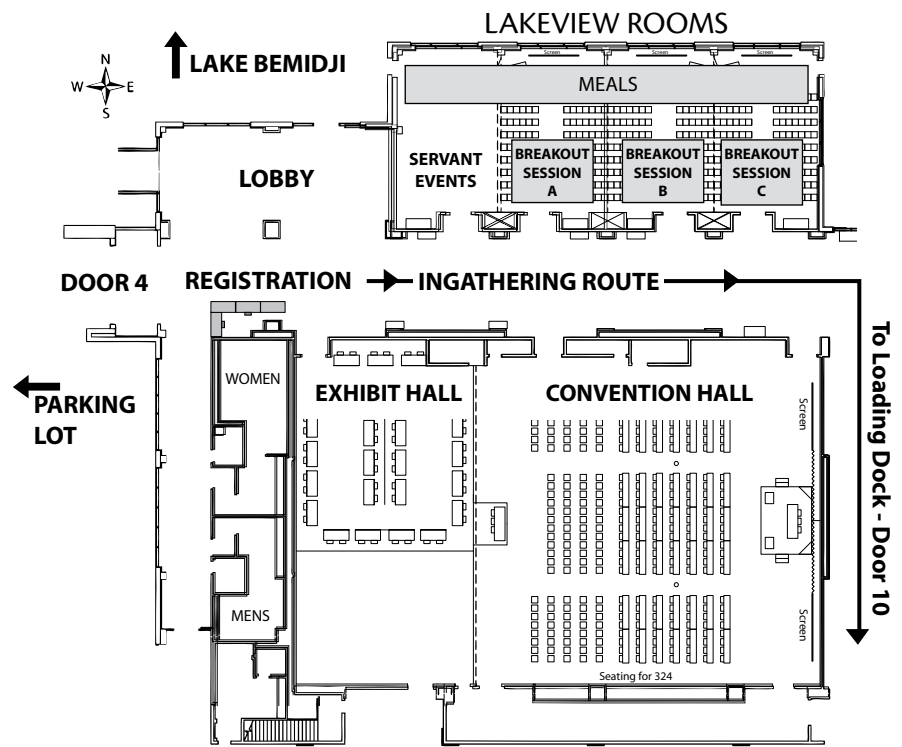

Convention Room Locations

- Registration (Lobby by Door 4)
- Exhibit Hall (Ballroom 1)
- LWML Store (Ballroom 1)
- Convention Hall (Ballrooms 2&3)
- Servant Events (Lakeview 4)
- Ingatherings (Lakeview 4) - Follow Route

Breakout Sessions

- Session A - Lakeview 5: Deb Larson
- Session B - Lakeview 6: Carole Borchers
- Session C - Lakeview 7: Cynthia Khan
- Mite Walk (Door 4) • Bus to Trinity Lutheran (Door 4) • Meals (Lakeview 4-7)
- Banners (Ballroom 1)

Zone/Society Group Photos

There will not be scheduled photo-taking times for zones or societies. If you want a photo of your group, you will need to gather your members together during a break and provide your own photographer.

For Dedication and Service – Thank You!

First, **I thank my God** through Jesus Christ for all of you, because your faith is proclaimed in all the world. (Romans 1:8)

The 28th Biennial Convention of the LWML Minnesota North District is underway. Once again, after months of planning and preparing, the ladies of the LWML are coming together to worship, study God's Word, sing praises, and fellowship with each other. Nuclei Committee Chairman Marcia Wittenburg has worked with Committee Chairs and District BOD members to make this convention memorable. Each member of the Nuclei Committee had their own assignment to bring this convention together. Our President Marilyn Hittel has spent countless hours answering and making phone calls, emails and letters, making sure that no detail is overlooked. The LWML members of Park I Region have volunteered their time and talents to this huge task.

The Bemidji Visitors and Convention Bureau and the staff of the George W. Neilson Convention Center have provided much information and assistance. The Country Inn and Suites have been answering our questions and providing accommodations in every way.

A big "thank you" to the City of Bemidji and all those who have helped with or provided snacks for the Mite Walk along the beautiful

Paul Bunyan Trail. Again. LCEF is providing bags for each convention participant and financing our Monday evening reception – we are grateful to them. We appreciate every exhibitor who took the time to attend our convention.

We thank the Slew Foot Family Band for providing entertainment on Tuesday night. Thank you for sharing your time and God-given talents.

We thank the congregation of Trinity Lutheran Church in Bemidji for use of their beautiful church to hold our opening worship service. We also thank the Pastoral Counselors and Rev. Robert Wentzel for planning and delivering a beautiful worship. We are thankful to the LWML members of Trinity Lutheran Church, for making and serving supper for the Board of Directors and all the other things they have done to make this convention a success.

To all the speakers, presenters, breakout session leaders, the choir and choir director, as well as the song leader – a big "Thank You" for your part in the convention.

And especially to you, the convention attendees, Thank You for making this convention part of your busy summer. We hope you are inspired, uplifted and blessed by your time here.

Thank you to everyone who made this 28th Biennial convention of the LWML Minnesota North District a reality.

Kathy Brandt, Park I Regional VP

Slew Foot Family Band

The Slew Foot Family Band Concert takes place on Tuesday evening, June 19, at 7:30 pm. If you know of a non-registered person who would like to attend, pick up a "ticket" for \$10 at the registration desk.

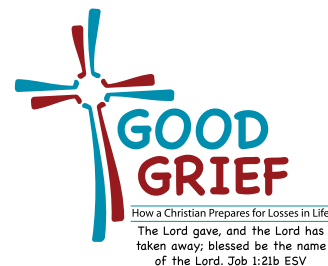

• SAVE THE DATE • 2018 LWML RETREAT "Good Grief: How a Christian Prepares for Losses in Life" Job 1:21b – August 10-12, 2018

Flyers and the registration form are available to download from the district website at, lwmlmnn.org.

Transition Meeting

There will be a transition meeting for all current Board members and all newly-elected Board members directly after the closing of the convention on Wednesday. Information will be shared regarding responsibilities and helps available for each Board member. More information will be announced during the convention as to time and location.

Thank you to those who have served and we welcome the new officers to this time of sharing!

*Kathy Brandt
Leader Development Chairman*

"Extra, Extra, Read All About It"

The next issue of the "Inscriptions and Inspirations" will be available after the BOD meeting in July. The convention newsletters are "special editions" of the district newsletter. Sign up to our eNews announcement list for the Minnesota Northern Light newsletter. Go to lwmlmnn.org, and look for the subscribe button!

Take a Tour of Bemidji

If you purchased a meal ticket, you will be eating at the Sanford Center. If not, there are a number of restaurants/fast food places within a close proximity of the Center. Our tour packet includes a listing of those restaurants along with addresses, phone #s, etc.

South Shores of Lake Bemidji has a walking/biking trail along the shores of Lake Bemidji. Bikes are available at \$5.50 per hour; make arrangements at the motel desk.

Our Downtown Bemidji has sculptures on the corners of the downtown – this can be viewed by car or walking. This is a rare look at the many different art creations displayed and enjoyed by our many visitors and guests.

Tours are available to see the Bemidji Woolen Mills or Watermark Art Center Gallery on June 20th, Wednesday from 1:30 - 2:30 pm. No signing up; just show up.

You don't want to miss our iconic Paul and Babe at the Chamber of Commerce Building. Check out our tour information folder to find out about even more sites to visit.

We have a very diverse culture here; we love to show our creativity and our heritage. We are very proud of our city. Hope you enjoy your stay; come back again soon.

“Pennies From Heaven”

How many pennies fit in a Mite Box? Stop by the Financial Officers' display and guess how many pennies can fit into a Mite Box. Maybe you'll win a prize! While there, pick up a Mite Box with the new LWML logo.



Nuclei Team Identification

At convention, you will be able to identify various Nuclei teams. For the most part, our team members will be wearing various scarf colors or caps as explained below:

Nuclei Committee Chairman and Park I Regional

VP: LWML butterfly-patterned scarves

Exhibitors Committee: Black and white-flowered scarves

Mite Walk Action Team: Thrivent T-shirts & buffalo plaid caps or Mite Walk T-shirts & caps

Sales: Red and white-checked arm bands

Servant Event Committee: Variegated purple scarves

Ushers/Hostesses: Red and black-checked scarves

Young Women: Purple hair bows

Thank you: Mite Walk donors

Matt in Sales and Promotions for Coca Cola graciously donated all the water for the Mite Walkers. We also thank Allen from Market Place Foods for the energy bars. We can thank and support them by purchasing their products.

We also thank Bill Batchelder of the Bemidji Woolen Mills, who gave us an extreme discount of fabric for the Buffalo Print used for scarves, bands, table runners, and caps.

Mustard Seed Devotions

Did you know you can go on the LWML website (www.lwml.org) and sign up to have the Mustard Seeds sent to your email daily? For Free!

It's fun to explore the LWML website to see all the things available.

Christian Life Exhibit

Come by the Christian Life table in the Exhibit Hall (Ballroom 1) and put your cares in the hands of the One Who Cares!

Learn more about LWML resources that can help your society.

Photographer: Deb Krueger

My faith journey has led me to want a servant's heart like Jesus.

Originally from the Twin Cities, Deb transplanted to Blackduck, MN and attends Holy Trinity Lutheran Church. She has been married 44 years; she has 3 children, 13 grandkids & a grand-dog. She has been taking photos since high school but seriously since 2008. She has done several art shows, some graduation portrait sessions, and has coordinated an Arts & Crafts Exhibit –The Midwinter Interlude, for faculty & staff at Bemidji State University for 9 years.

Deb loves sharing the beauty of God's creation with photo greeting cards and recording our journey through this amazing world with pictures.

It's a chance to witness of Jesus' love for us with each card, photo, art & craft. We are all so blessed.

Take a Step Back

Available at the Archivist-Historian Booth—for donation to Mite Fund: 2012 Convention Tacks; 2014 Convention Tacks & Charms.

Exhibits for the 28th Biennial Convention

Hooray for the Exhibitors!

Give a great big welcome to the Exhibitors that have joined the MN North Convention in the Exhibit Hall (Ballroom 1). The Exhibitors would like to share their information with all the convention attendees. Please make sure that you visit them throughout the convention. It is always uplifting to hear how these wonderful groups are serving the Lord and spreading His Word. (It is also fun to enjoy the candy.)

During the convention sessions, the Exhibit Hall will be closed. Exhibitors are invited to join us in our convention sessions.

The Exhibit hours are as follows:

Mon, June 18 (11:00 am - 6:00 pm)

Tues, June 19 (7:00 am - 8:00 am)

(12:00 noon-1:15 pm, end of session - 7:30 pm)

Exhibitors are open from end of Tues. session until 7:30 pm

Exhibitors tear-down begins at 7:30 pm

The following exhibitors will be attending:

CLEF

Concordia Theological Seminary

Fort Wayne

District Archivist-Historian

District Christian Life

District Financial

District Human Care

District Mission Grants

District Public Relations

District Structure

District Young Women

Lutheran Bible Translators

Lutheran Braille Workers

Lutheran Church Extension Fund

Lutheran Heritage Foundation

Lutheran Hour Ministries

Lutheran Island Camp

Lutheran Mission Association

Lutherans for Life

LWML Store

Most Ministries

Orphan Grain Train



LWML Invites you to the 38th Biennial Convention

Thursday, June 20–Sunday, June

23, 2019 | Mobile Convention Center | Mobile, Alabama

“In Praise to the Lord”

The convention theme is based on the Scripture verse, “Sing to the Lord, all the earth! Tell of his salvation from day to day. Declare his glory among the nations” (1 Chronicles 16:23–24a).

Convention Goal

Led by God’s power, we praise and proclaim the Lord among all the nations.

Convention Objectives

- Sing and rejoice in celebration of His Word.
- Tell of His salvation for all.
- Declare His glory among the nations.
- Go forth in His joy!

For more LWML convention information visit: www.lwml.org.

Share Your Convention Experience

Share your pictures and stories with us. If you took an interesting “convention photo”, why not share it with us? We are always looking for information to help our district better share and communicate with each other.

If you have society/zone events (and we know you do), why not share them with the other churches and societies in our district?

From Mother/Daughter Teas to Aunt Selma’s 90th birthday celebration—we’d love to see/read about your activities in the *Minnesota Northern Light* and the *LW Supplement*. Share the joy!

Please send all information to the Editor at, editor@lwmlmnn.org.



2018 UPCOMING EVENTS

July 10 - Lutheran Witness supplement page deadline

July 10 - LWML MN North Board of Directors Meeting, Baxter, MN

August 10 - Lutheran Witness supplement page deadline

August 10-12 - The 2018 LWML Retreat “Good Grief: How a Christian Prepares for Losses in Life” Job 1:21b at Lutheran Island Camp, Henning, MN

October 9 - LWML MN North Board of Directors Meeting, Baxter, MN



MITES IN ACTION SPEAKERS



Orphan Grain Train

Our Story

Eugene Pasche is a member at Zion Lutheran Church in Morris and has served in many positions and currently is an elder. He has served in several positions on the MN North District Lutheran Laymen's League Board. He currently serves as Manager of MN North Orphan Grain Train Collection Center. Orphan Grain Train collects and provides humanitarian aid to those in need.

About the presentation: Eugene will share a brief summary of how Orphan Grain Train is organized and has functioned nationwide for the last 25 years. It will explain the collection, packing and shipping process. Included is a brief description of some of the recipients of humanitarian aid. Thank you to the women of LWML MN North for their tremendous work and support.

DOXOLOGY

Presented by Rev. Bruce Timm, Redeemer Evangelical Lutheran, Saint Cloud, MN

DOXOLOGY, a charitable nonprofit 501(c)3 corporation and RSO of The Lutheran Church—Missouri Synod, is comprised of pastors, counselors and laity from various walks of life who are committed to the Gospel of Jesus Christ, especially as God gives it through the Holy Ministry. DOXOLOGY offers an innovative program of advanced study retreats to strengthen pastors for the task of faithfully shepherding the souls entrusted to their care. The primary purpose of our organization is to provide training, mentoring and consultation services for pastors seeking to enhance their ability to help people struggling with the ever-increasing personal, family and social complexities of contemporary life.

Lutheran Island Camp + Christ Serve Ranch

The mission and work of Lutheran Island Camp and Christ Serve Ranch

Kenneth Erlandson has been blessed to serve as the Lutheran Island Camp Executive Director since December of 2001. He is a 1985 graduate of Concordia College St. Paul in the DCE program. He and his wife, Toni, will be celebrating their 28th anniversary in August. The Lord has blessed them with 8 children and in October of 2017 with a son-in-law.

About the presentation: From the beginning of Lutheran Island Camp, the LWML has supported the work and mission of Lutheran Island Camp. On behalf of the camp board and staff I want to thank the LWML for their prayers and support. Our theme this year is "By Faith" and we want to give an update on the camp and the work at Christ Serve Ranch.

C.R.O.S.S. Appeal

The Blessings of Mites in Action to the C.R.O.S.S. Appeal (Congregations Reaching Out to Support Schools)

Janna Kietzman has been serving the Minnesota North District in Lutheran Education for over 30 years. She is currently the principal and teacher at Immanuel Lutheran School at Walker, MN. She has a heart for the mission of Lutheran Schools and a passion for sharing the Good News of Jesus with God's children.

About the presentation: The Lutheran schools in the MN North District would like to thank the LWML for their generous gift to the C.R.O.S.S. Appeal, share a summary of the purpose of C.R.O.S.S., and report on how the funds have helped to enrich and strengthen the educational ministry of our schools.